



DPE-S-PT Series

Differential Pressure Flow meter
to Provide Reliable Flow Solutions

FEATURE

- CE - LVD(2014/35/EC), EMC(2014/30/EU), RoHS(2011/65/EU)
- Automatic correction of temperature and pressure
- Applicable to most of fluids
- Can be used for high temperature and pressure fluids and their piping conditions
- Momentary flow and integrated flow can be easily checked on the monitor
- High precision even under fluctuating temperature and pressure conditions
- The output signal can be linked with various devices
- Can be freely installed horizontally and vertically
- Can be manufactured with a small diameter up to a large diameter
- Explosion Proof Certification : Ex d IIC T5 / IP67)

APPLICATIONS

- ▶ Chemical and Other Process Industries
 - Injecting fibric products with adhesiveness
 - Emulsified liquid including latex and emulsion.
 - Condensate and Cooling water
- ▶ Refinery & Gas Industry
 - Injection plant for corrosion, scaling and hydrate inhibitors
 - Nitrogen, Flue gas, etc.
- ▶ Machinery and Equipment (OEM industry)
 - Coolant, Coolant, Lubricant, Air supply
- ▶ Water resources
 - Spray oxygen on the aeration basin
 - Air injection to reduce iron content
- ▶ Power plants and Nuclear power industry

<https://dlk.com.vn/>

Email: info@dlk.com.vn



DPE-S-PT General Specifications



Size	10A (3/8") - 500A (20")
Process Connection	Flange type - KS / JIS / ANSI / ASME / DIN Std. Taper Pipe Thread type (PT)
Measured Fluid	Gas and Liquid
Flow Ranges	Water - 0.1 m ³ /h ~ 2500 m ³ /h Air - 0.8 Nm ³ /h ~ 24000 Nm ³ /h
Range Ability	10 : 1
Accuracy	±2.0 % F.S (Option ±1.0 % F.S)
Fluid Temperature	Max 120 °C (Option 350 °C)
Ambient Temperature	-10 °C ~ 60 °C
Max. Pressure	Max. 20 kgf/cm ² .G (Option 50 kgf/cm ² .G)
Power Supply	AC 110/220 V (50~60 Hz)
Display	4 Lines LCD Mass Flow, Volume Flow in Standard Condition, Totalizer, Velocity, Time
Output	DC 4-20 mA, Pulse, RS485 (Modbus RTU), Contact (High, Low)
Explosion Proof Grade	Ex d IIC T5
Ingress Protection Grade	IP 67

STRUCTURAL DRAWING

Combination Type (Air / Liquid Under 100°C)

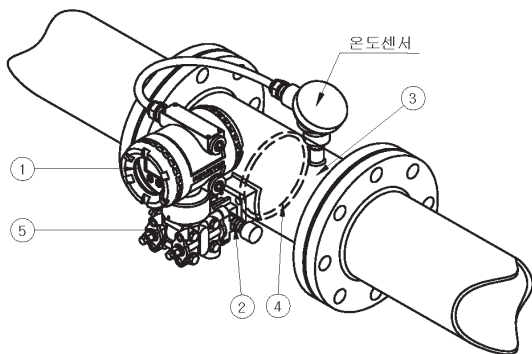

Separable Type (Steam / Hot Gas)

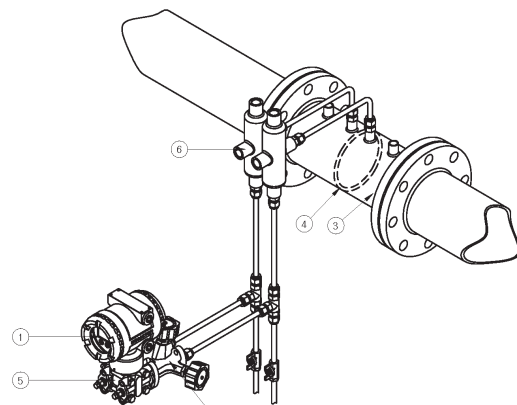



MODEL CODE

D	P	E	-	□	-	□□	Specification
				S			Digital Indicator
						P	Auto Pressure Correction
						T	Auto Temperature Correction
						PT	Auto Pressure & Temperature Correction



STANDARD MATERIAL

No.	Description	Material		
		A	B	C
1	Transmitter	ADC12		
2	3-Way Valve	304SS		316SS
3	Orifice Body	SS400	304SS	316SS
4	Orifice	304SS		316SS
5	DP Seal	316SS		

FLOW RANGE & DIMENSIONS

Connection size		Flow Ranges		Length (mm)	
		Water (m ³ /h)	Air (Nm ³ /h)	Flange	Screw
10A	3/8 B	0.05 - 0.5	0.4 - 4	350	70
15A	1/2 B	0.1 - 1.0	1 - 10	350	70
20A	3/4 B	0.25 - 2.5	2.5 - 25	350	70
25A	1 B	0.5 - 5	5 - 50	350	70
32A	1-1/4 B	1 - 10	6 - 60	350	70
40A	1-1/2 B	1.5 - 15	10 - 100	350	74
50A	2 B	2.5 - 25	20 - 200	350	85
65A	2-1/2 B	3.5 - 35	30 - 300	350	100
80A	3 B	5 - 50	40 - 400	350	100
100A	4 B	8 - 80	80 - 800	350	-
125A	5 B	12.5 - 125	125 - 1250	350	-
150A	6 B	20 - 200	170 - 1700	350	-
200A	8 B	30 - 300	280 - 2800	400	-
250A	10 B	50 - 500	500 - 5000	400	-
300A	12 B	80 - 800	780 - 7800	400	-
350A	14 B	100 - 1000	950 - 9500	400	-
400A	16 B	150 - 1500	1450 - 14500	400	-
450A	18 B	200 - 2000	1900 - 19000	400	-
500A	20 B	250 - 2500	2400 - 24000	400	-

<https://dlk.com.vn/>

Email: info@dlk.com.vn

DK

INSTALLATION



DPE Series can be installed freely up, down, left, and right as shown in the figure below.

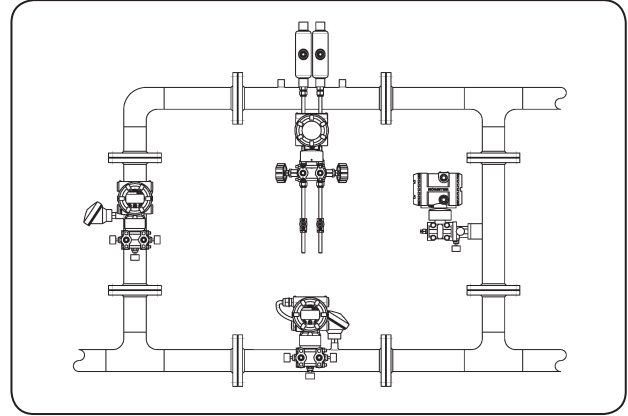
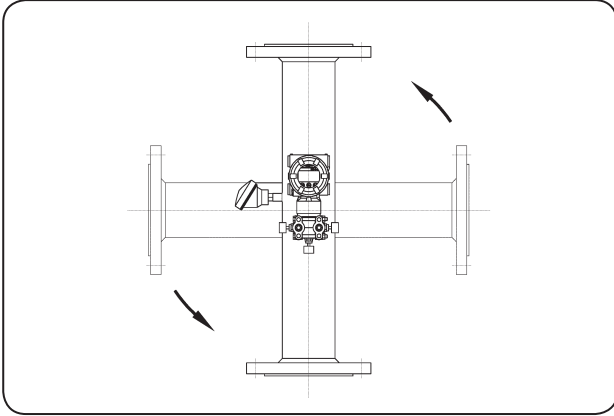

If the installation site of the flow meter is a place where it is difficult to read the flow rate, the connector can be separated as shown in the figure to facilitate reading.

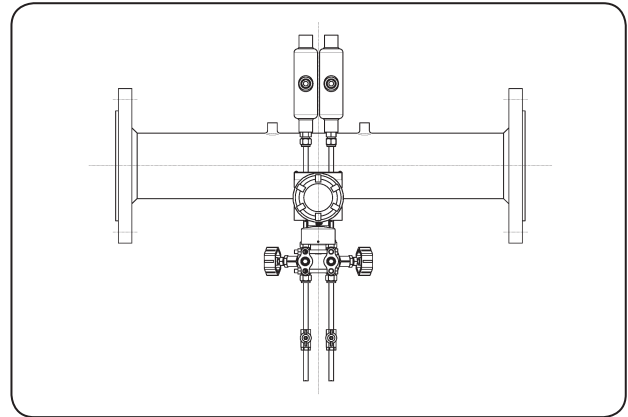
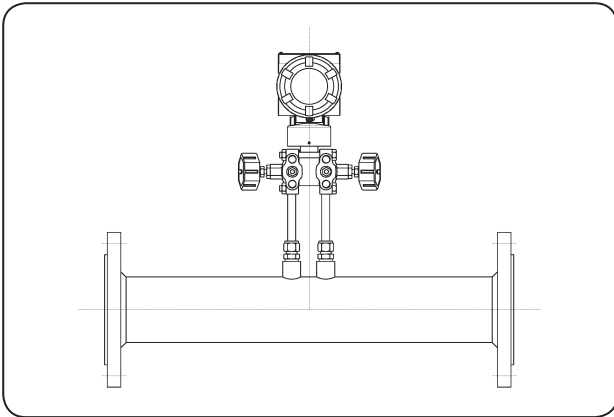

INSTALLATION PRECAUTIONS

1. The transition of the main pipe and the diameter of the test pipe need not be consistent.
2. The pipe before and after the flow meter needs a straight pipe to maintain its degree.

